

LUMIÈRE CONFIGURATION - F (NO LIGHTS)

LUMIÈRE LIGHT WALL

PRODUCT CODE: LLW20X15FNL



On frame On graphic

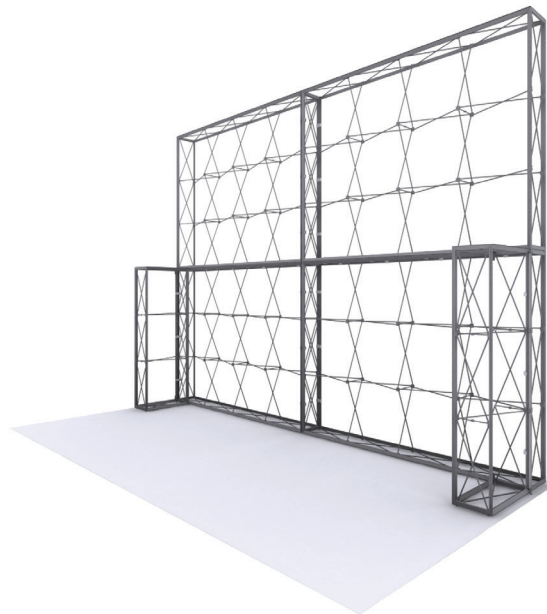

Straight Connector



L Link Connector

PRODUCT DESCRIPTION

Introducing the Lumiere Light Wall! A combination of innovative silicone-edge graphics and RPL fabric pop ups offers an easier and more cost effective SEG option. This SEG style display has the depth of the RPL so you can expose more of your message using endcap graphics. The Lumiere shrinks down in size - simply collapse the geometric frame and the SEG bungeed channel bars, and fold or roll the fabric graphics. Setup can be done by 1 person and in 5-10 minutes. SEG portability is easy and stylish.

DISPLAY DIMENSION	236.2" W x 177" H x 44.5" D
-------------------	-----------------------------

GRAPHIC DIMENSIONS

4X3 MAIN GRAPHICS	118.5" W x 89" H (8 Graphics)
4X3 END CAP GRAPHICS	14.25" W x 89" H (4 Graphics)
1X3 MAIN GRAPHICS	30.5" W x 89" H (4 Graphics)
1X3 END CAP GRAPHICS	14.25" W x 89" H (2 Graphics)

FRAME CONFIGURATION QUANTITY

4X3 FRAME	4 Frames
1X3 FRAME	2 Frames

GRAPHIC MATERIAL

Stretch Fabric

GRAPHIC FINISHING

Silicone beading is sewn around the perimeter of the fabric graphic. Silicone beading is hidden from view once installed.

DISPLAY CONSTRUCTION

Aluminum Frame

SHIPPING WEIGHTS & DIMENSIONS

4x3 Lumiere Light Wall (4 boxes total)

Shipping Weight	35 lbs (frame only) (each box) 39 lbs (with graphics) (each box)
Shipping Dimensions	34" L x 14" W x 9" H (each box)

1x3 Lumiere Light Wall (2 boxes total)

Shipping Weight	20 lbs (frame only) (each box) 24 lbs (with graphics) (each box)
Shipping Dimensions	34" L x 14" W x 9" H (each box)

GRAPHIC TURN AROUND TIME

6 business days after proof approval

AVAILABILITY	CA and PA
--------------	-----------

LUMIÈRE CONFIGURATION - F (NO LIGHTS)

LUMIÈRE LIGHT WALL
PRODUCT CODE: LLW20X15FNL

AVAILABLE ACCESSORIES



Lumiere Front Lit -
Black Light LED



Lumiere Front Lit -
Silver Light LED



Lumiere Black Light
(150 W)



Lumiere Silver Light
(150 W)



T135 LED Light



LED Light Bracket



Qty 4 -Stabilization Feet

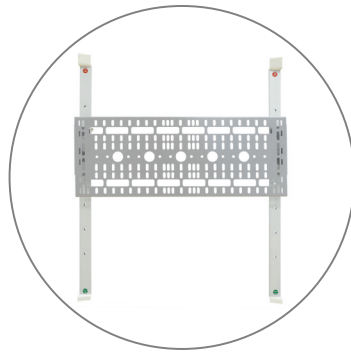

Monitor Bracket

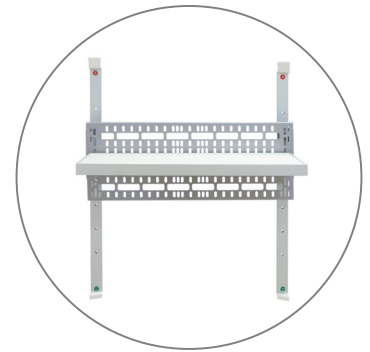

Shelf



Internal Showcase



La Caja Case



Genie Counter Case

LUMIÈRE CONFIGURATION - F (NO LIGHTS)

LUMIÈRE LIGHT WALL

PRODUCT CODE: LLW20X15FNL

PARTS LIST



Qty 4 - 4x3 Pop Up Frame



Qty 2 - 1x3 Pop Up Frame



Qty 16 - 4 Section Channel Bars



Qty 24 - 3 Section Channel Bars



Qty 8 - 1 Section Channel Bars

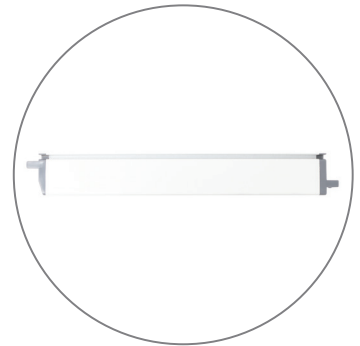

Qty 24 - End Cap Channel Bars



Qty 6 - Carry Bags



Qty 6 - Channel Bar Bags



Qty 28 - Straight Connectors



Qty 6 - L Link Connectors

LUMIÈRE CONFIGURATION - F (NO LIGHTS)

LUMIÈRE LIGHT WALL

PRODUCT CODE: LLW20X15FNL

SET UP INSTRUCTIONS

Set Up Pop Up Frame



a. Place frame with the adjustable feet facing down.

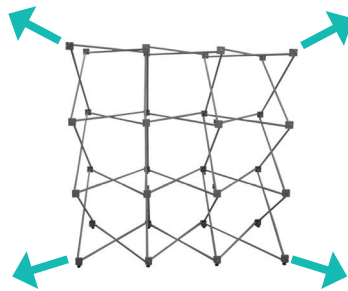

b. Expand the frame.

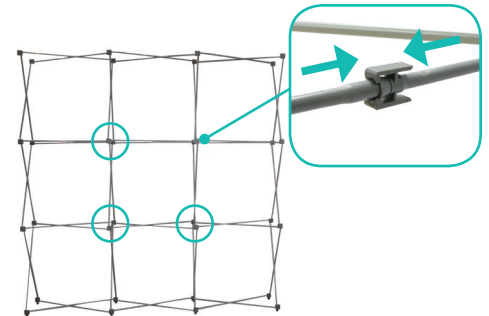

c. Close frame by pushing the outside of the frame until male and female ends connect.

Insert Channel Bars

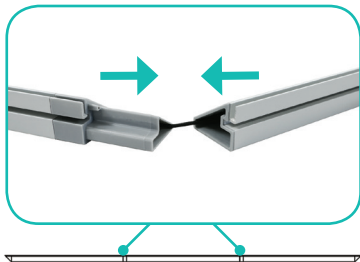

a. Expand each channel bar. Follow bungee to connect.

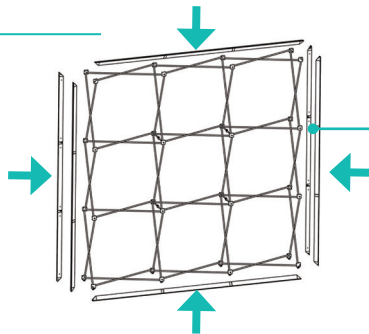

b. Attach channel bars to frame.

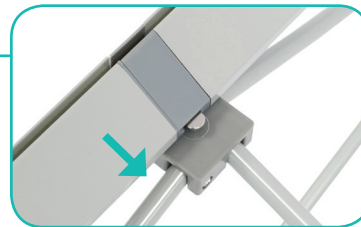

c. Slide channels bars onto frame, from top to bottom, then secure onto metal peg.



d. Attach the top and bottom end caps on each side of the frame.

Install Graphic



a. In each corner, insert the silicone edge beading into the groove.



b. Then insert the remainder of the beading.



c. Repeat graphic installation on the end caps.

Optional Accessories

Light Bracket:

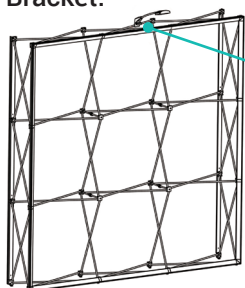

a. Snap the LED Light Bracket on top of the frame. Then slide the LED Light onto the bracket.



Stabilized Feet:

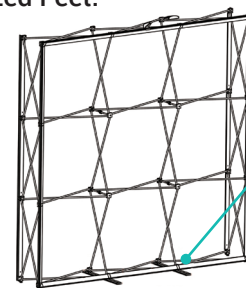

a. From the back, lift frame and insert adjustable feet onto stabilized feet. Then slide stabilized feet toward and insert onto the adjustable feet.

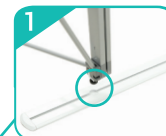

LUMIÈRE CONFIGURATION - F (NO LIGHTS)

LUMIÈRE LIGHT WALL
PRODUCT CODE: LLW20X15FNL

SET UP INSTRUCTIONS

Connecting Wall

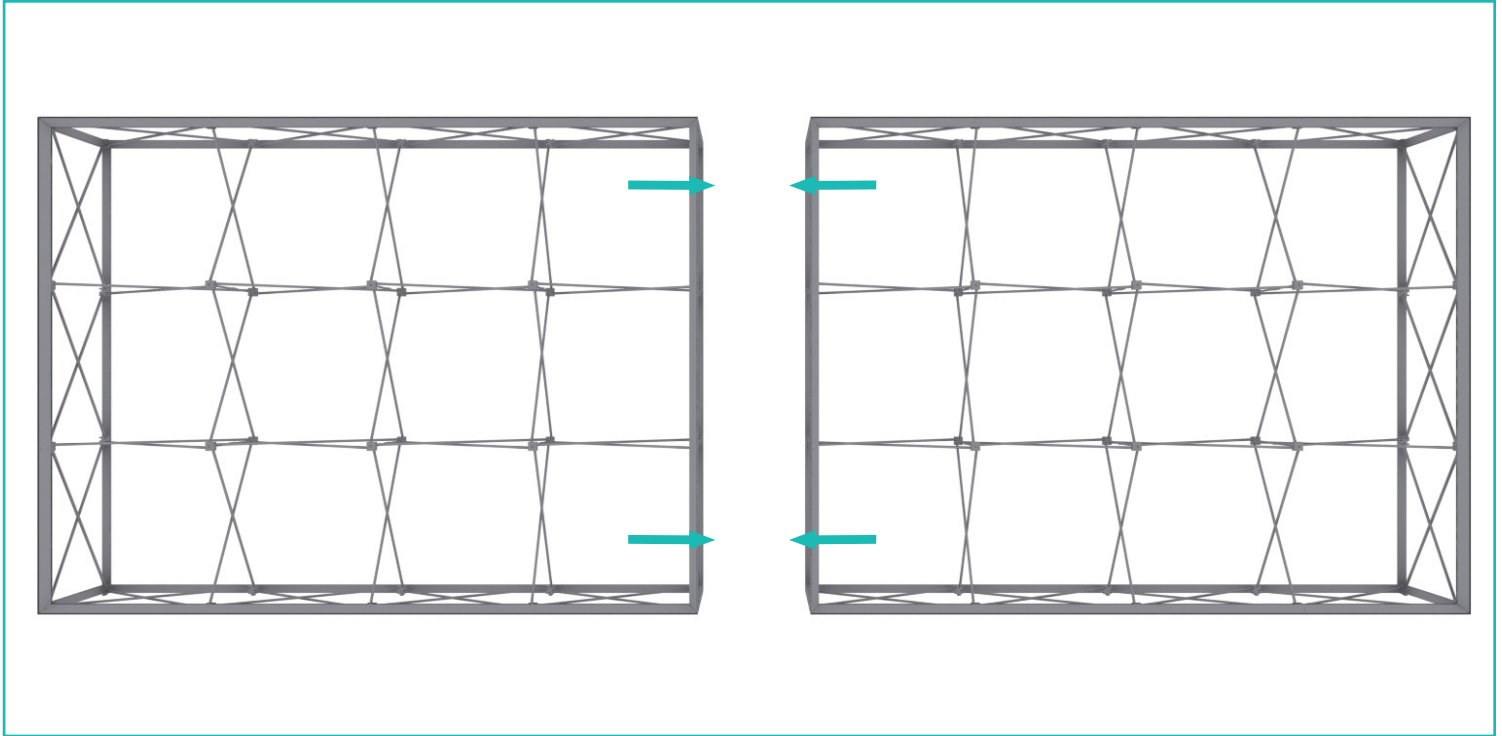

Place the (2) 4x3 frames side by side.

Note: Rendering shown without graphics for clarity.

Straight Connection



1
*Starting from behind, make sure the frames are flushed next to each other.

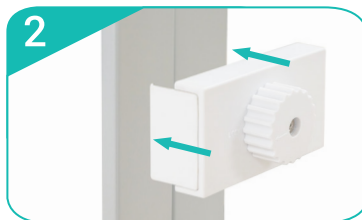

2
Slide Straight Connector onto the channel bars of both frames.

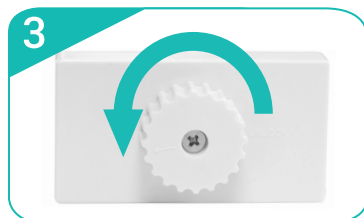

3
Turn dial to the left to lock the Straight Connector in place. Repeat for each vertical sections (6 total).

Note: Repeat process when frames are stack together (6 total).



4

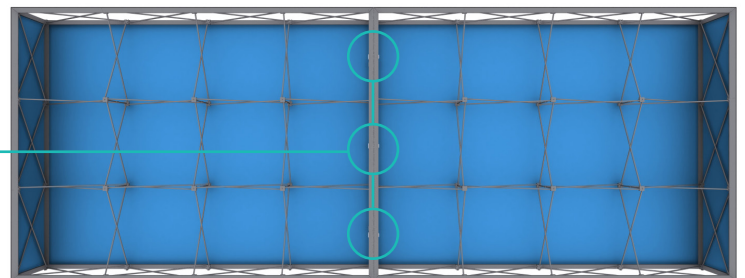

*Back side of the 4x3's shown above.

LUMIÈRE CONFIGURATION - F (NO LIGHTS)

LUMIÈRE LIGHT WALL

PRODUCT CODE: LLW20X15FNL

SET UP INSTRUCTIONS

Connecting Top Walls

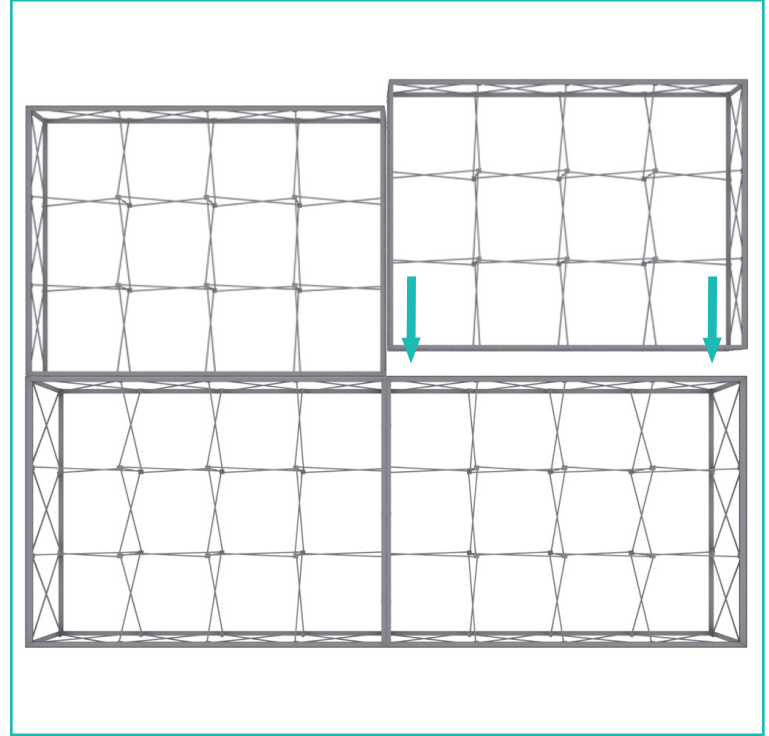
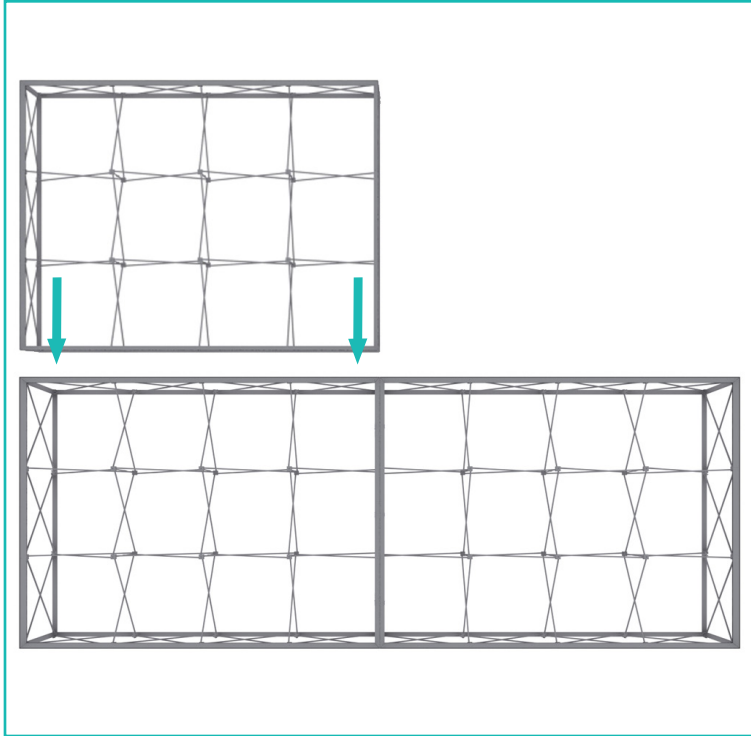

Place the 4x3 frames on top of the 4x3 frames.

Note: 2 people are required to hold each side of the top frame while the third person secures with the Straight Connectors. Repeat process for other top frame.

Note: Rendering shown without graphics for clarity. 4x3 front side graphics must be installed first before placing the frames on top.

Straight Connection



*Starting from behind, make sure the frames are flushed next to each other.

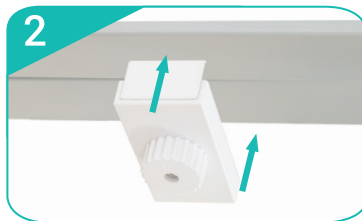

Slide Straight Connector onto the channel bars of both frames.

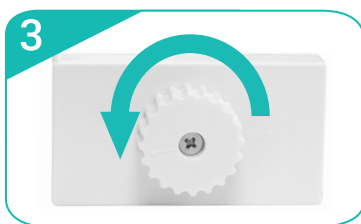

Turn dial to the left to lock the Straight Connector in place. Repeat for each vertical sections (8 total).

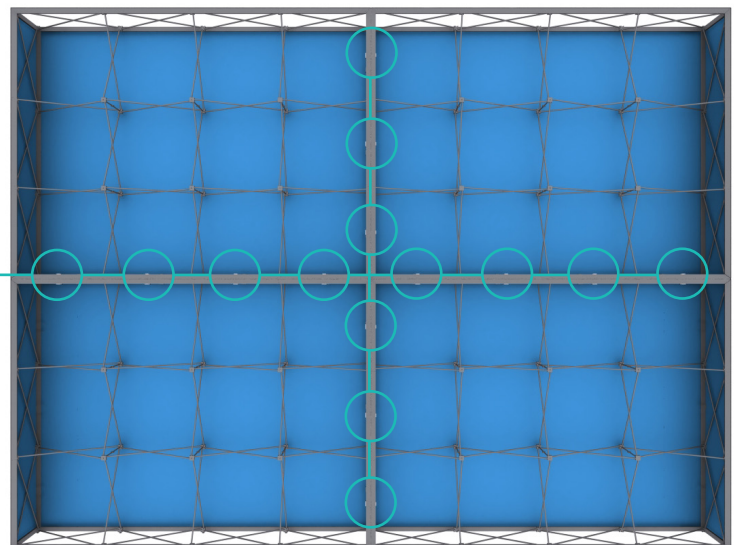

*Back side of the stacked 4x3 frames shown above.

LUMIÈRE CONFIGURATION - F (NO LIGHTS)

LUMIÈRE LIGHT WALL
PRODUCT CODE: LLW20X15FNL

SET UP INSTRUCTIONS

Connecting Return Walls

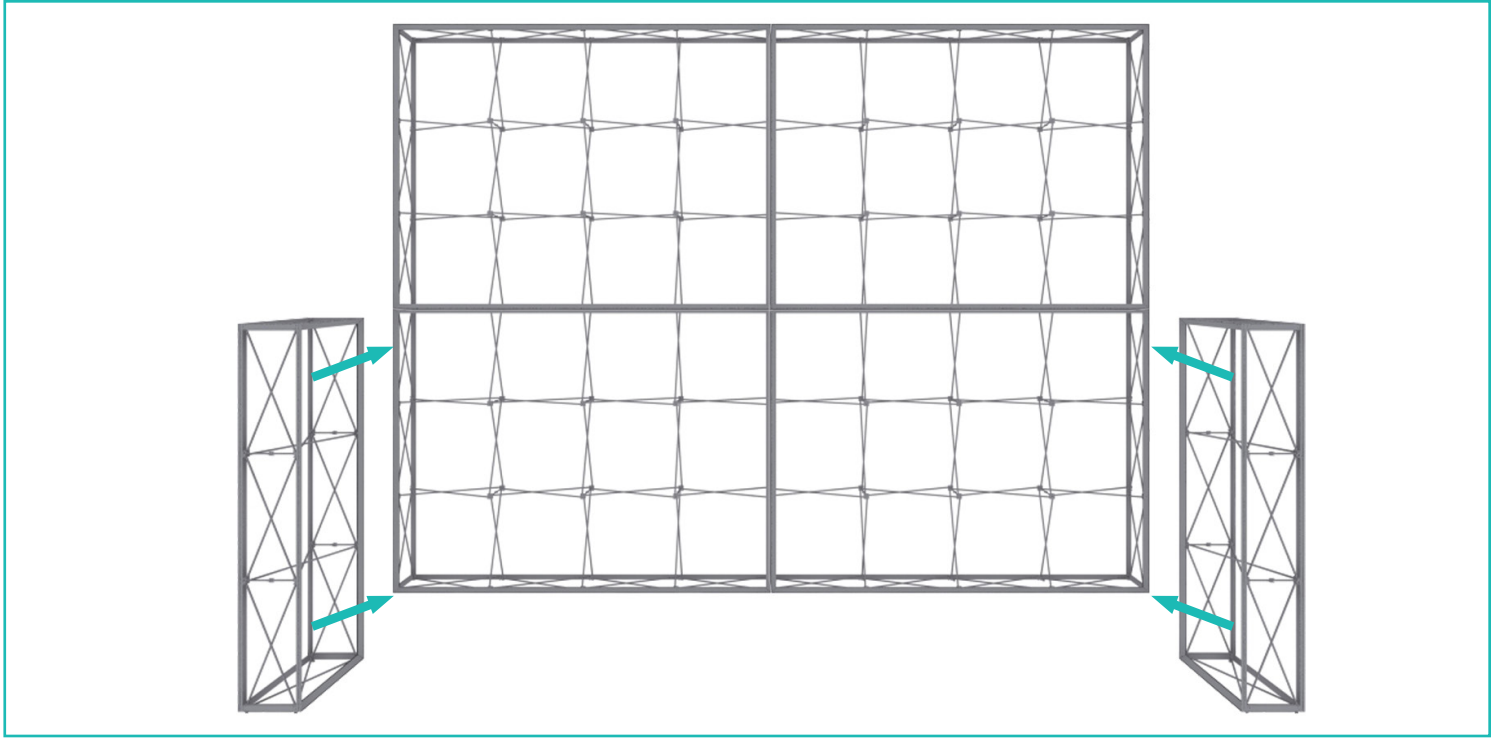

Adjoin the 1x3 frame perpendicular (90° angle) to the front side of the 4x3 frame.

Note: Rendering shown without graphics for clarity. 4x3 front side graphic must be installed before connecting frames.

L Link Connection



*Starting from behind, pull the 4x3 graphic away to make space for L Connector.



Slide L Connector onto the channel bars of both frames.

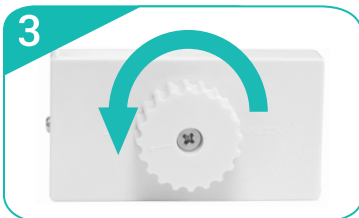

Turn dial to the left to lock the L Connector in place. Repeat for each vertical section (6 total).

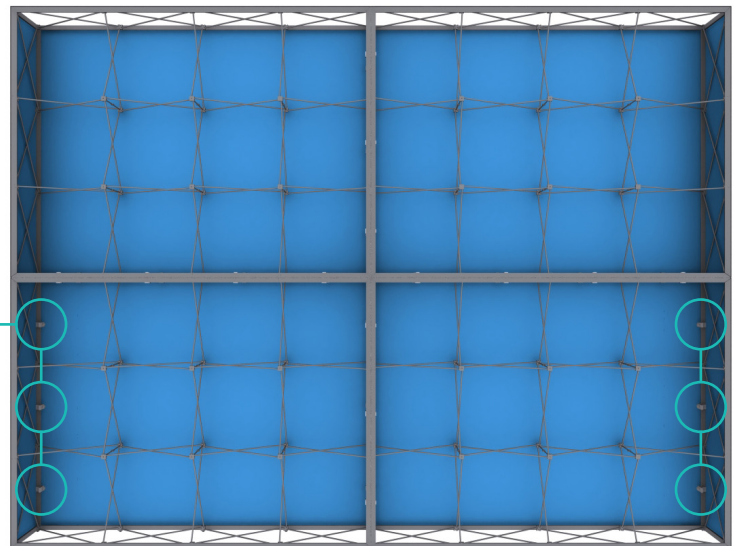

*Back side of 4x3 shown above.

LUMIÈRE CONFIGURATION - F (NO LIGHTS)

LUMIÈRE LIGHT WALL

PRODUCT CODE: LLW20X15FNL

TEMPLATE GUIDE

Front View

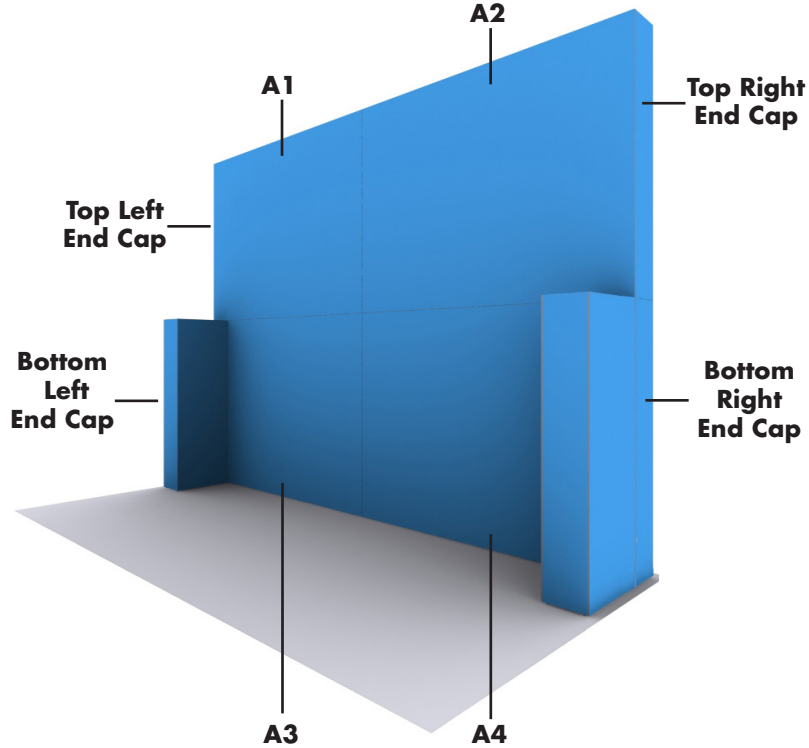

TOP LEFT END CAP	<p>A1 - LUMIÈRE CONFIGURATION F (4x3 TOP LEFT FRONT GRAPHIC) Non-Backlit / Backlit</p> <p>Print Size (with bleed): 118.5" x 89" Yellow Safe Area: 112.5" x 83.5" Finished Size: 117.5" x 88" End Cap Print Size (with bleed): 14.25" x 89" End Cap Yellow Safe Area: 9.5" x 83.5" Finished Size: 13.375" x 88"</p> <p><small>Keep all your important graphics within top, left, and bottom dimensions in the yellow safe zone. Blue area will print.</small></p> <p><small>DISCLAIMER: Any continuous artwork may not line up properly.</small></p> <p>TEMPLATE ARE AT 1/2 SCALE</p>	<p>A2 - LUMIÈRE CONFIGURATION F (4x3 TOP RIGHT FRONT GRAPHIC) Non-Backlit / Backlit</p> <p>Print Size (with bleed): 118.5" x 89" Yellow Safe Area: 112.5" x 83.5" Finished Size: 117.5" x 88" End Cap Print Size (with bleed): 14.25" x 89" End Cap Yellow Safe Area: 9.5" x 83.5" Finished Size: 13.375" x 88"</p> <p><small>Keep all your important graphics within top, left, and bottom dimensions in the yellow safe zone. Blue area will print.</small></p> <p><small>DISCLAIMER: Any continuous artwork may not line up properly.</small></p> <p>TEMPLATE ARE AT 1/2 SCALE</p>	TOP RIGHT END CAP
BOTTOM LEFT END CAP	<p>A3 - LUMIÈRE CONFIGURATION F (4x3 BOTTOM LEFT FRONT GRAPHIC) Non-Backlit / Backlit</p> <p>Print Size (with bleed): 118.5" x 89" Yellow Safe Area: 98" x 83.5" Finished Size: 117.5" x 88" End Cap Print Size (with bleed): 14.25" x 89" End Cap Yellow Safe Area: 9.5" x 83.5" Finished Size: 13.375" x 88"</p> <p><small>Keep all your important graphics within top, left, and bottom dimensions in the yellow safe zone. Blue area will print.</small></p> <p><small>DISCLAIMER: Any continuous artwork may not line up properly.</small></p> <p>TEMPLATE ARE AT 1/2 SCALE</p>	<p>A4 - LUMIÈRE CONFIGURATION F (4x3 BOTTOM RIGHT FRONT GRAPHIC) Non-Backlit / Backlit</p> <p>Print Size (with bleed): 118.5" x 89" Yellow Safe Area: 98" x 83.5" Finished Size: 117.5" x 88" End Cap Print Size (with bleed): 14.25" x 89" End Cap Yellow Safe Area: 9.5" x 83.5" Finished Size: 13.375" x 88"</p> <p><small>Keep all your important graphics within top, left, and bottom dimensions in the yellow safe zone. Blue area will print.</small></p> <p><small>DISCLAIMER: Any continuous artwork may not line up properly.</small></p> <p>TEMPLATE ARE AT 1/2 SCALE</p>	BOTTOM RIGHT END CAP

THIS AREA WILL BE COVERED

THIS AREA WILL BE COVERED

LUMIÈRE CONFIGURATION - F (NO LIGHTS)

LUMIÈRE LIGHT WALL

PRODUCT CODE: LLW20X15FNL

TEMPLATE GUIDE

Back View

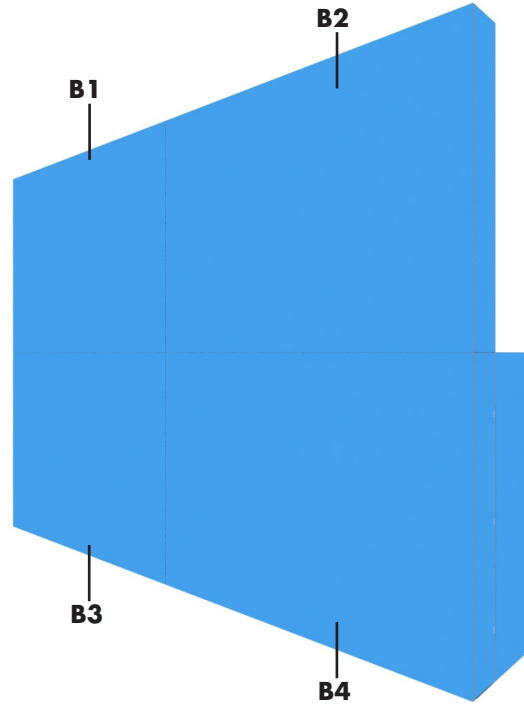

B1 - LUMIERE CONFIGURATION F (4x3 TOP LEFT BACK GRAPHIC) Non-Backlit / Backlit

Print Size (with bleed): 118.5" x 89"
Yellow Safe Area: 112.5" x 83.5"
Finished Size: 117.5" x 88"
End Cap Print Size (with bleed): 14.25" x 89"
End Cap Yellow Safe Area: 9.5" x 83.5"
Finished Size: 13.375" x 88"

Keep all your important graphics
(such as logos, text, and contact information)
in the yellow safe zone.
Blue area will print

DISCLAIMER:
Any continuous artwork may not line up properly
TEMPLATE ARE AT 1/2 SCALE

B2 - LUMIERE CONFIGURATION F (4x3 TOP RIGHT BACK GRAPHIC) Non-Backlit / Backlit

Print Size (with bleed): 118.5" x 89"
Yellow Safe Area: 112.5" x 83.5"
Finished Size: 117.5" x 88"
End Cap Print Size (with bleed): 14.25" x 89"
End Cap Yellow Safe Area: 9.5" x 83.5"
Finished Size: 13.375" x 88"

Keep all your important graphics
(such as logos, text, and contact information)
in the yellow safe zone.
Blue area will print

DISCLAIMER:
Any continuous artwork may not line up properly
TEMPLATE ARE AT 1/2 SCALE

B3 - LUMIERE CONFIGURATION F (4x3 BOTTOM LEFT BACK GRAPHIC) Non-Backlit / Backlit

Print Size (with bleed): 118.5" x 89"
Yellow Safe Area: 112.5" x 83.5"
Finished Size: 117.5" x 88"
End Cap Print Size (with bleed): 14.25" x 89"
End Cap Yellow Safe Area: 9.5" x 83.5"
Finished Size: 13.375" x 88"

Keep all your important graphics
(such as logos, text, and contact information)
in the yellow safe zone.
Blue area will print

DISCLAIMER:
Any continuous artwork may not line up properly
TEMPLATE ARE AT 1/2 SCALE

B4 - LUMIERE CONFIGURATION F (4x3 BOTTOM RIGHT BACK GRAPHIC) Non-Backlit / Backlit

Print Size (with bleed): 118.5" x 89"
Yellow Safe Area: 112.5" x 83.5"
Finished Size: 117.5" x 88"
End Cap Print Size (with bleed): 14.25" x 89"
End Cap Yellow Safe Area: 9.5" x 83.5"
Finished Size: 13.375" x 88"

Keep all your important graphics
(such as logos, text, and contact information)
in the yellow safe zone.
Blue area will print

DISCLAIMER:
Any continuous artwork may not line up properly
TEMPLATE ARE AT 1/2 SCALE

LUMIÈRE CONFIGURATION - F (NO LIGHTS)

LUMIÈRE LIGHT WALL

PRODUCT CODE: LLW20X15FNL

TEMPLATE GUIDE

Front View

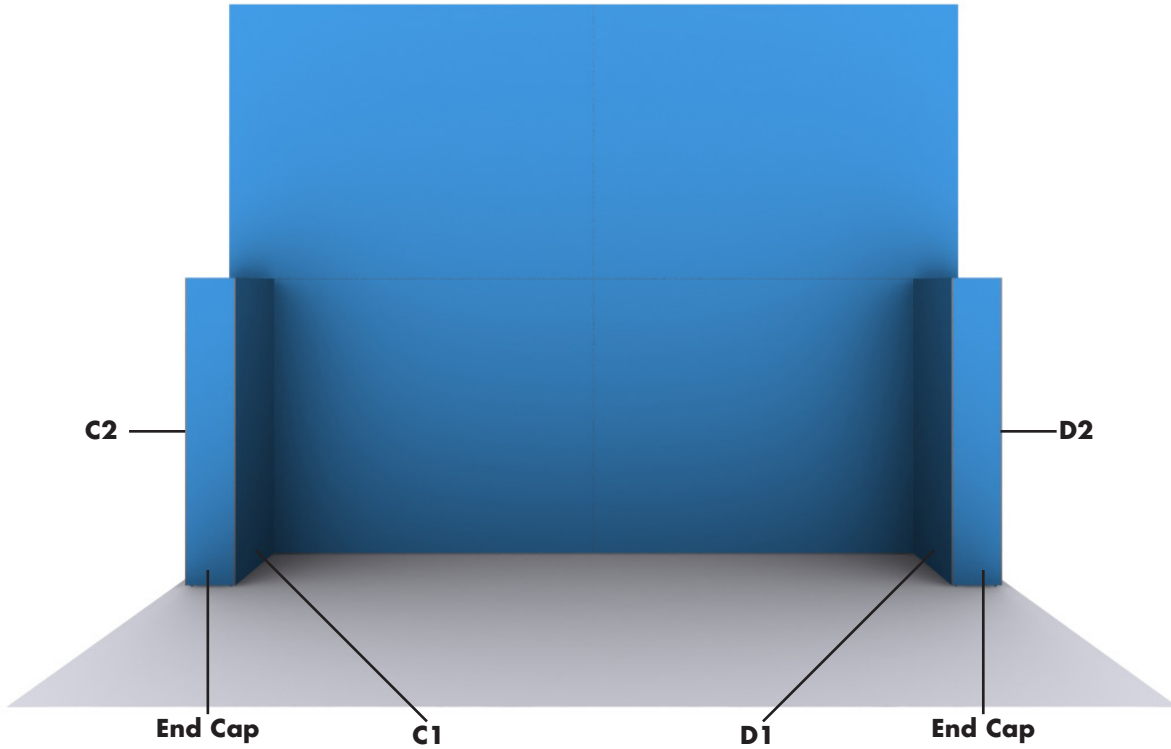

<p>C2 - LUMIERE CONFIGURATION F (1x3 LEFT RETURN WALL GRAPHIC) Non-Backlit / Backlit</p> <p>Print Size (with bleed): 31.5" x 89" Yellow Safe Area: 25.5" x 83.5" Finished Size: 30.5" x 88" End Cap Print Size (with bleed): 14.25" x 89" End Cap Yellow Safe Area: 9.5" x 83.5" Finished Size: 13.375" x 88"</p> <p>Keep all your important graphics such as logos, text, and contact information in the yellow safe zone. Blue area will print</p> <p>DISCLAIMER: Any continuous artwork may not line up properly</p> <p>TEMPLATE ARE AT 1/2 SCALE</p>	<p>END CAP</p>	<p>C1 - LUMIERE CONFIGURATION F (1x3 LEFT RETURN WALL GRAPHIC) Non-Backlit / Backlit</p> <p>Print Size (with bleed): 31.5" x 89" Yellow Safe Area: 25.5" x 83.5" Finished Size: 30.5" x 88" End Cap Print Size (with bleed): 14.25" x 89" End Cap Yellow Safe Area: 9.5" x 83.5" Finished Size: 13.375" x 88"</p> <p>Keep all your important graphics such as logos, text, and contact information in the yellow safe zone. Blue area will print</p> <p>DISCLAIMER: Any continuous artwork may not line up properly</p> <p>TEMPLATE ARE AT 1/2 SCALE</p>
---	-----------------------	---

Ver-1011.17

<p>D1 - LUMIERE CONFIGURATION F (1x3 RIGHT RETURN WALL GRAPHIC) Non-Backlit / Backlit</p> <p>Print Size (with bleed): 31.5" x 89" Yellow Safe Area: 25.5" x 83.5" Finished Size: 30.5" x 88" End Cap Print Size (with bleed): 14.25" x 89" End Cap Yellow Safe Area: 9.5" x 83.5" Finished Size: 13.375" x 88"</p> <p>Keep all your important graphics such as logos, text, and contact information in the yellow safe zone. Blue area will print</p> <p>DISCLAIMER: Any continuous artwork may not line up properly</p> <p>TEMPLATE ARE AT 1/2 SCALE</p>	<p>END CAP</p>	<p>D2 - LUMIERE CONFIGURATION F (1x3 RIGHT RETURN WALL GRAPHIC) Non-Backlit / Backlit</p> <p>Print Size (with bleed): 31.5" x 89" Yellow Safe Area: 25.5" x 83.5" Finished Size: 30.5" x 88" End Cap Print Size (with bleed): 14.25" x 89" End Cap Yellow Safe Area: 9.5" x 83.5" Finished Size: 13.375" x 88"</p> <p>Keep all your important graphics such as logos, text, and contact information in the yellow safe zone. Blue area will print</p> <p>DISCLAIMER: Any continuous artwork may not line up properly</p> <p>TEMPLATE ARE AT 1/2 SCALE</p>
--	-----------------------	--

Ver-1011.17