

LUMIÈRE CONFIGURATION - E

LUMIÈRE DISPLAY - SETUP INSTRUCTIONS

Connecting Top Wall

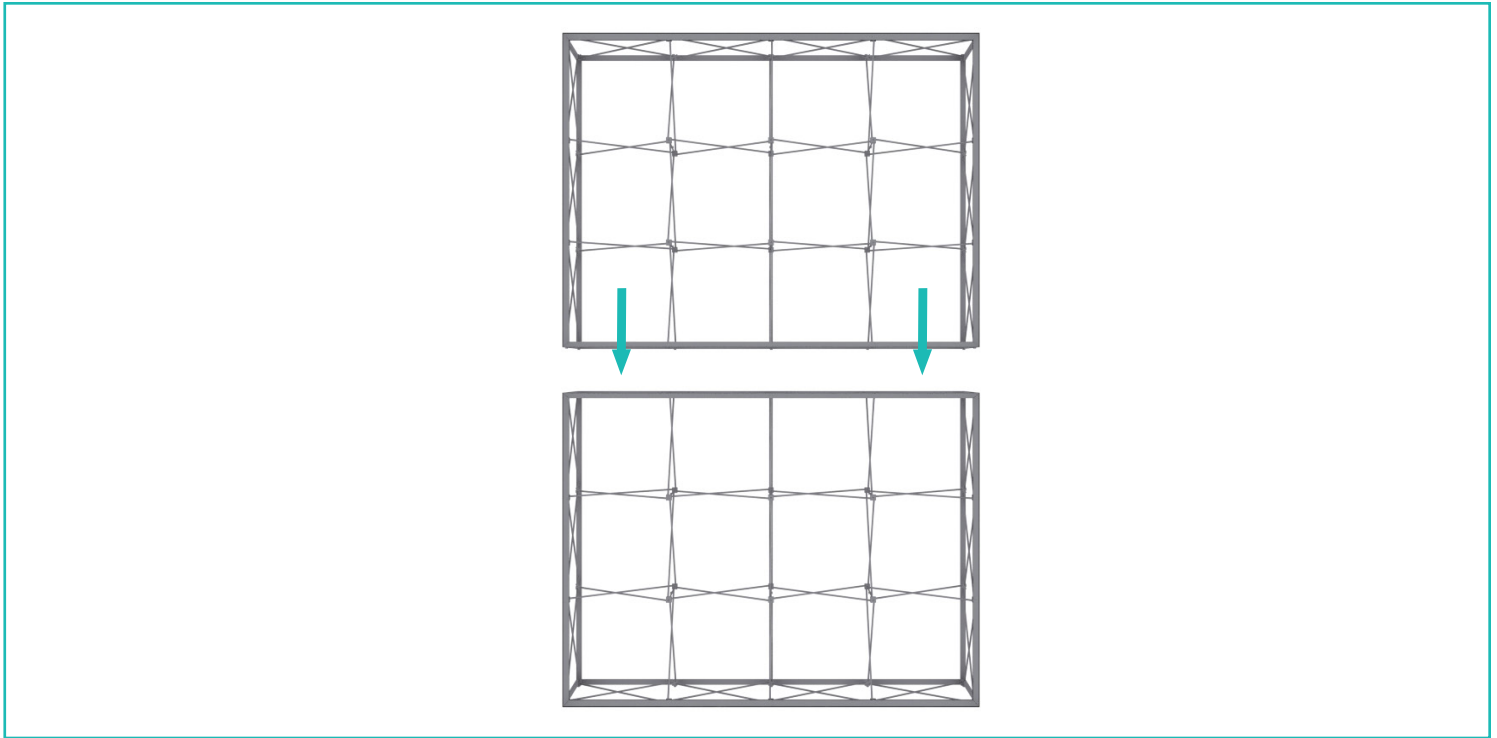

Place the 4x3 frame on top of the 4x3 frame.

Note: 2 people are required to hold each side of the top frame while the third person secures with the Straight Connectors.

Note: Rendering shown without graphics for clarity. 4x3 front side graphic must be installed first before placing the frames on top.

Straight Connection



1
*Starting from behind, make sure the frames are flushed next to each other.

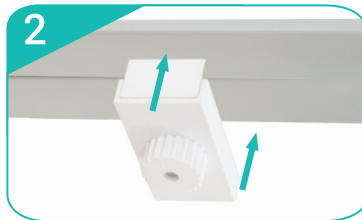

2
Slide Straight Connector onto the channel bars of both frames.

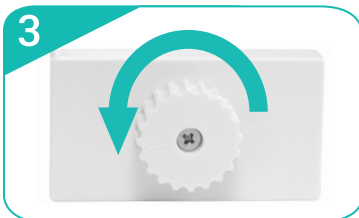

3
Turn dial to the left to lock the Straight Connector in place. Repeat for each vertical sections (8 total).



4

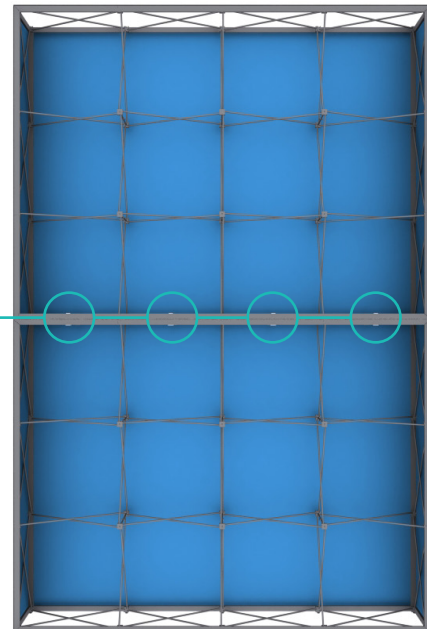

*Back side of the stacked 4x3 frames shown above.