

LUMIÈRE CONFIGURATION - F

LUMIÈRE DISPLAY - SETUP INSTRUCTIONS

Connecting Wall

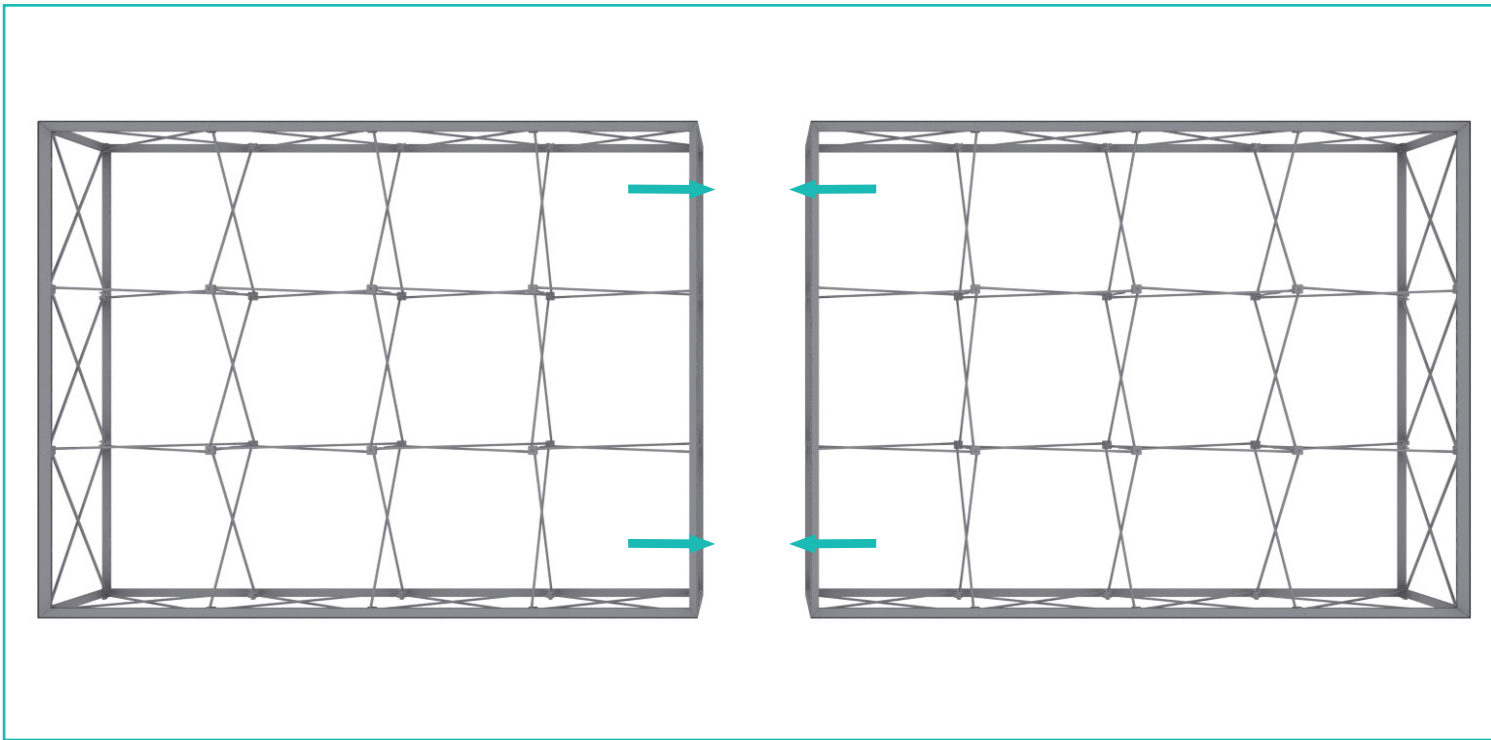

Place the (2) 4x3 frames side by side.

Note: Rendering shown without graphics for clarity.

Straight Connection



*Starting from behind, make sure the frames are flushed next to each other.

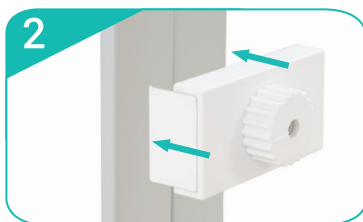

Slide Straight Connector onto the channel bars of both frames.

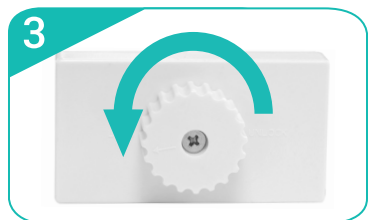

Turn dial to the left to lock the Straight Connector in place. Repeat for each vertical sections (6 total).

Note: Repeat process when frames are stack together (6 total).

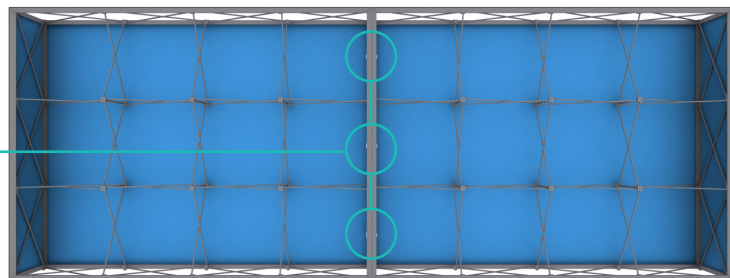

*Back side of the 4x3's shown above.

LUMIÈRE CONFIGURATION - F

LUMIÈRE DISPLAY - SETUP INSTRUCTIONS

Connecting Top Wall

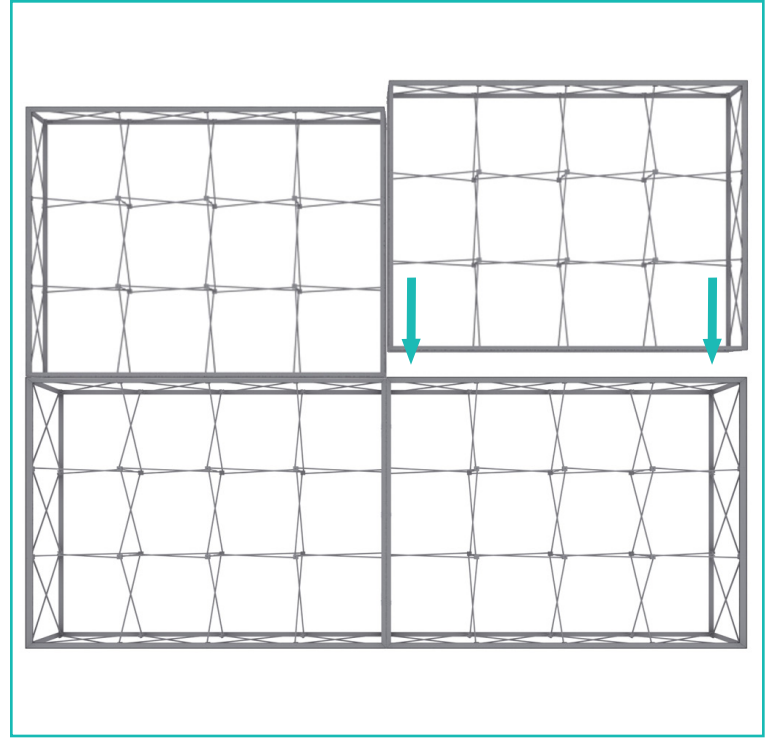
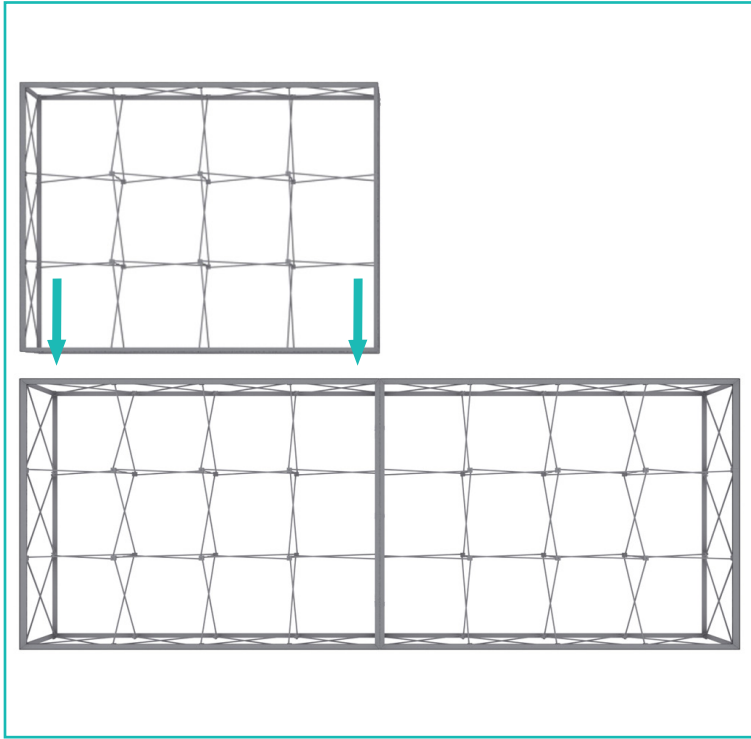

Place the 4x3 frames on top of the 4x3 frames.
Note: 2 people are required to hold each side of the top frame while the third person secures with the Straight Connectors. Repeat process for other top frame.

Note: Rendering shown without graphics for clarity. 4x3 front side graphics must be installed first before placing the frames on top.

Straight Connection



*Starting from behind, make sure the frames are flushed next to each other.

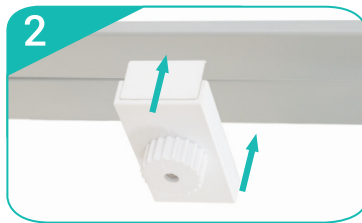

Slide Straight Connector onto the channel bars of both frames.

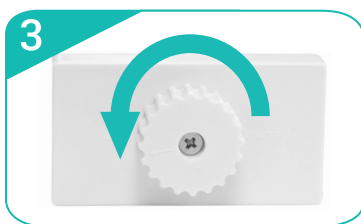

Turn dial to the left to lock the Straight Connector in place. Repeat for each vertical sections (8 total).

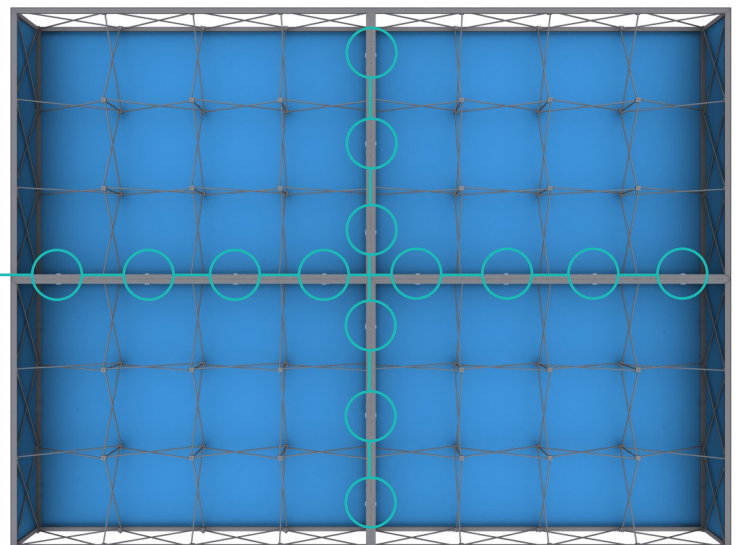

*Back side of the stacked 4x3 frames shown above.

LUMIÈRE CONFIGURATION - F

LUMIÈRE DISPLAY - SETUP INSTRUCTIONS

Connecting Return Wall

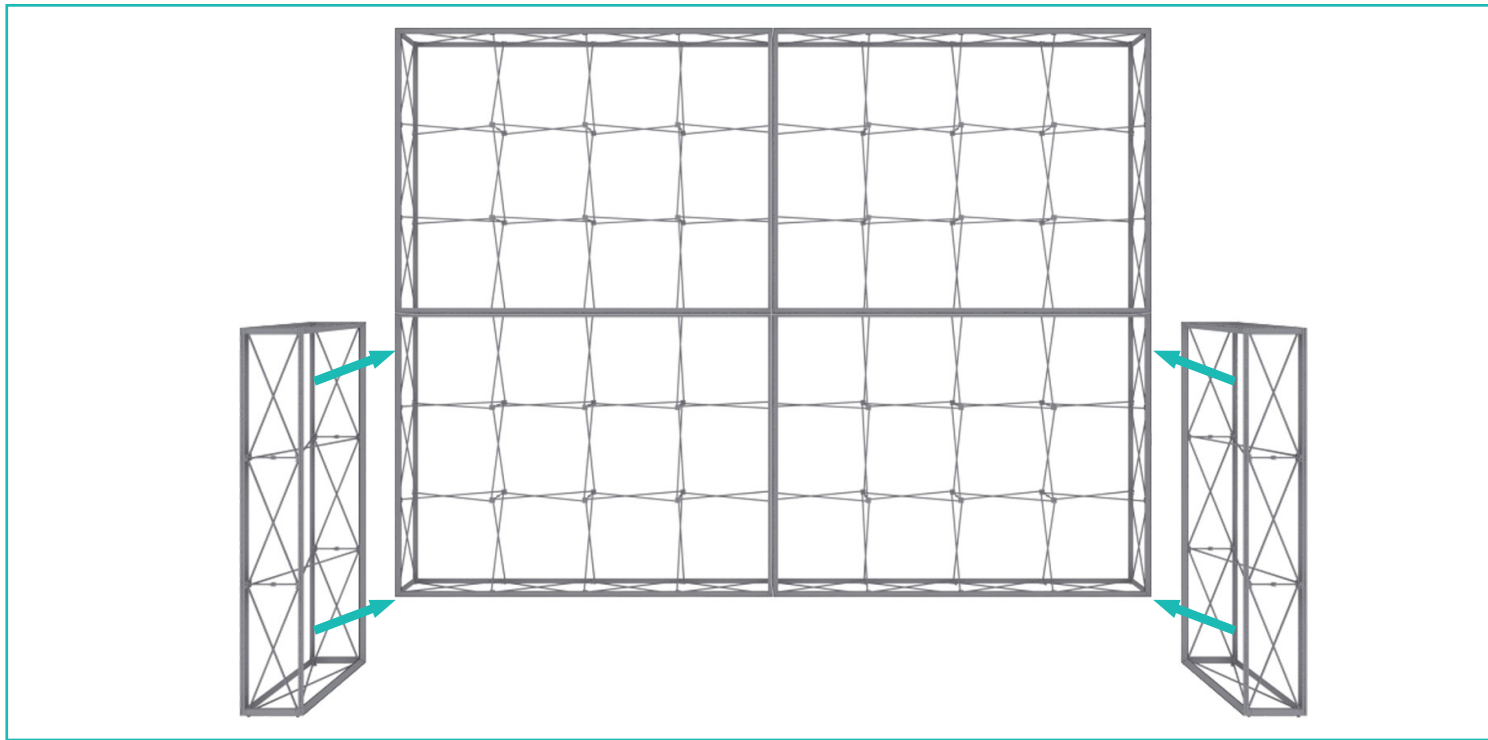

Adjoin the 3x3 frame perpendicular (90o angle) to the front side of the 4x3 frame.

Note: Rendering shown without graphics for clarity. 4x3 front side graphic must be installed before connecting frames.

L Link Connection



1 *Starting from behind, pull the 4x3 graphic away to make space for L Connector.



2 Slide L Connector onto the channel bars of both frames.

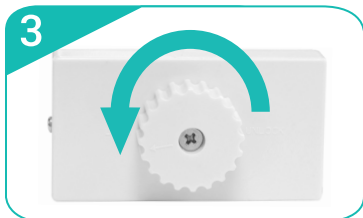

3 Turn dial to the left to lock the L Connector in place. Repeat for each vertical section (3 total).

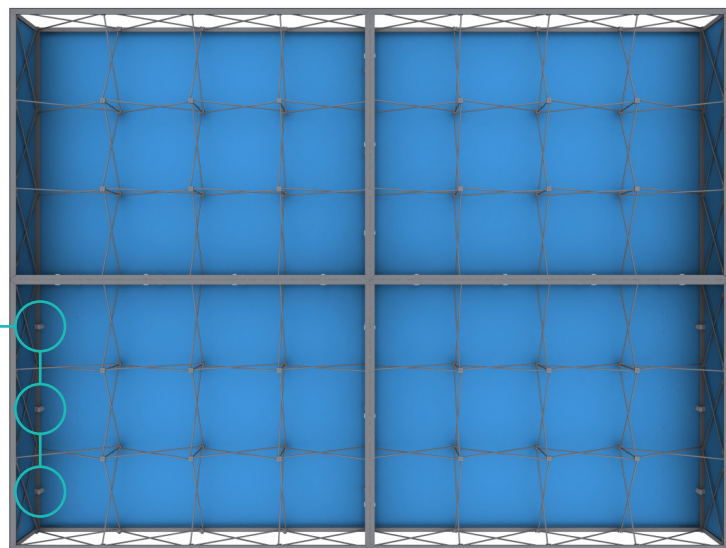

*Back side of 4x3 shown above.